

MODERN FLAMES

AMBIANCE LINEAR 40

AMBIANCE LINEAR 60

AMBIANCE LINEAR 100

SAFETY INFORMATION AND OPERATIONS MANUAL



Read these instructions completely before beginning installation. Failure to follow them could cause a heater malfunction resulting in serious injury and/or property damage.

WARNING: All electric heaters have hot and arcing or sparking parts inside. Do not use it in areas where gasoline, paint or flammable liquids are or are stored.

This fireplace meets the construction and safety standards of H.U.D. for application in manufactured homes when installed according to these instructions.

INSTALLER: Leave this manual with the appliance.
CONSUMER: Retain this manual for future reference.

Table of Contents

Safety.....	2	Installation.....	6
Listing Approvals.....	3	Operation.....	9
Product Dimensions.....	4	Service Parts.....	10
Box Contents.....	5	Frequently Asked Questions.....	12
Unpacking and Testing.....	5	Troubleshooting.....	13
Locating Fireplace.....	6		

Safety

WARNING: Improper installation, adjustment, alteration, service or maintenance can cause injury or property damage. Refer to this manual. For assistance or additional information, consult a qualified installer.

CAUTION: Do not expose the heater to the elements (such as rain, etc).

Do not place clothing or other flammable material on or near firebox. Never place any objects on the fireplace.

Carefully supervise young children when they are in the room with fireplace.

Fireplace becomes very hot when running. Keep children and adults away from hot surfaces to avoid burns or clothing ignition. Fireplace will remain hot for a time after shutdown. Allow surfaces to cool before touching.

Do not install fireplace directly on carpet or similar surface which may restrict air circulation beneath unit.

When using electrical heaters, basic precautions should always be followed to reduce the risk of fire, electric shock and injury to persons, including the following:

1. Read all instructions before using this heater.
2. Keep combustible materials, such as furniture, pillows, bedding, papers, clothes and curtains away from front of heater. 1.5 yards minimum clearance required.
3. This heater is hot when in use. To avoid burns, do not let bare skin touch hot surfaces. The grill directly in front of heater outlet becomes hot during heater operation.
4. Extreme caution is necessary when any heater is used and whenever heater is left operating and unattended.
5. Always unplug heater when not in use.
6. Do not operate any heater with a damaged cord or plug or if heater malfunctions or has been dropped or damaged in any way. Return heater to authorized service facility for examination, electrical or mechanical adjustment or repair.
7. Do not use outdoors.
8. This heater is not intended for use in bathrooms, laundry areas and similar

Safety

- indoor locations. Never locate heater where it may fall into a bathtub or other water container.
9. Do not run cord under carpeting. Do not cover cord with throw rugs, runners or the like. Arrange cord away from traffic area and where it will not be tripped over.
 10. To disconnect heater, turn controls to the OFF before removing plug from outlet.
 11. Do not insert or allow foreign objects to enter any ventilation or exhaust opening as this may cause an electric shock or fire or damage the heater.
 12. To prevent possible fire, do not block air inlets or outlets in any manner. Do not use on soft surfaces, like a bed, where openings may become blocked.
 13. Always use properly grounded fused and polarized outlets.
 14. A heater has hot and arcing or sparking parts inside. Do not use it in areas where gasoline, paint or flammable liquids or vapors are used or stored.
 15. Use this heater only as described in this manual. Any other use not recommended by the manufacturer may cause fire, electric shock or injury to persons.
 16. Avoid the use of an extension cord because the extension cord may overheat and cause a risk of fire. However, if you have to use an extension cord, the cord should be No. 14 AWG minimum size and rated not less than 1875 WATTS.
 17. Always use ground fault protection where required by electrical codes.
 18. Always disconnect power before performing any cleaning, maintenance or relocation of heater.
 19. To prevent a possible fire, do not burn wood or other materials in this heater.
 20. To prevent electric shock or fire, always use a certified electrician should new circuits or outlets be required.
 21. When transporting or storing heater, keep in a dry place.
 22. Control panel door gets hot during heater operation. Open door by pressing on right corner. A spring magnet will disengage. Pull door down to open.
 23. SAVE THESE INSTRUCTIONS

Listing Approvals

This heater has been tested in accordance with the CSA Standards for fixed and location-dedicated electric room heaters in the United States. This fire-place is UL or CSA safety certified.

	AL-100 CLX	AL-60CLX	AL-40 CLX
Volts	AC 120V/60Hz	AC 120V/60Hz	AC 120V/60Hz
Amps	15 Amp	15 Amp	15 Amp
Watts	1570 W	1530 W	1520 W
Heater	AC 120V/60Hz 1500W	AC 120V/60Hz 1500W	AC 120V/60Hz 1500W
No Heater			
Lamps	LED DC12V 5W*7 LED DC3V 3W*8	LED DC12V 5W*3 LED DC3V 3W*4	LED DC12V 5W*3
Rotor motor	AC 120V/60Hz 4W CCW 15/18 r/min	AC 120V/60Hz 4W CCW 15/18 r/min	AC 120V/60Hz 4W CCW 15/18 r/min
Shipping Size	2600*230*800mm	1590*230*800mm	1080*230*800mm
Shipping Weight			

Product Dimensions

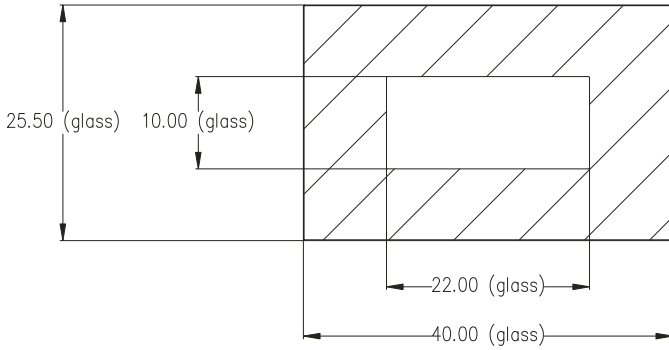

AL CLX 40
40" W x 25.5" H x 3.48" D

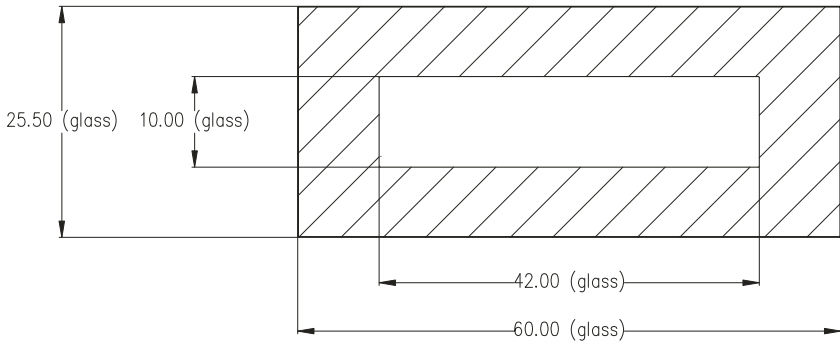

AL CLX 60
60" W x 25.5" H x 3.48" D

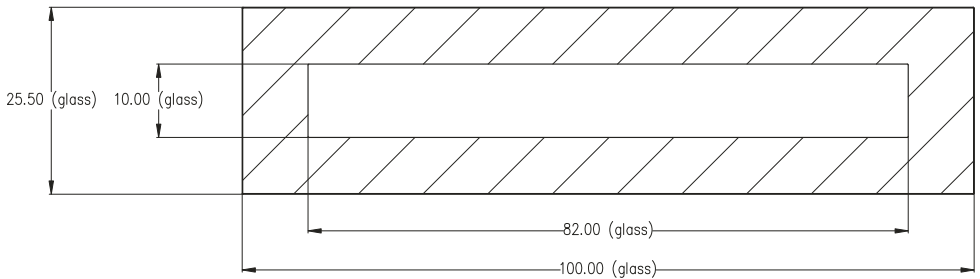

AL CLX 100
100" W x 25.5" H x 3.48" D

Box Contents

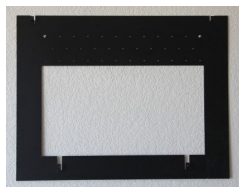

1 Mounting
Bracket



4 Wall Anchors



1 Fire Unit



8 Small Washer
Head Screws



1 Glass Face



4 Large Washer
Head Screws



3 L-metal
Brackets



1 Remote

Unpacking and Testing

Carefully remove unit from box. Prior to permanently installing unit, test to make sure unit operates properly. To do this, plug unit's power supply cord into a conveniently located 120-volt grounded outlet.

WARNING: Do not operate the unit if it is damaged or has malfunctioned. If you suspect the unit is damaged, return the unit to an authorized service facility for examination, electrical or mechanical adjustment or repair.

CAUTION: The unit's power supply cord must be connected to a properly grounded and protected 120-volt outlet. Always use ground fault protection where required by the electrical code.

Locating Fireplace

CAUTION: Do not expose the heater to the elements (such as rain, etc.)

CAUTION: Wear gloves and safety glasses for protection during installation and maintenance.

This electric fireplace can be installed framed in to a wall or simply hung on the wall.

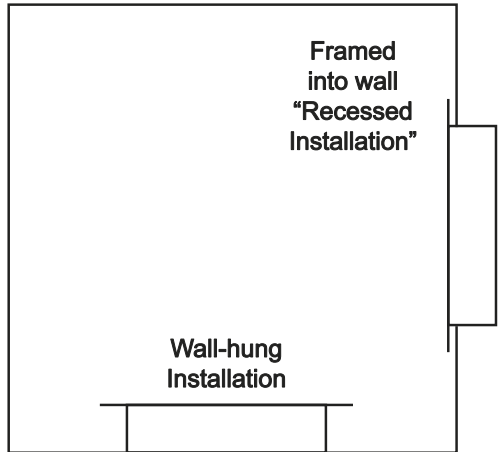

Installation

WARNING - RISK OF FIRE!

The power cord must not be pinched or against a sharp edge. Secure cord to avoid tripping or snagging to reduce the risk of fire, electric shock or personal injury.

Do not run cord under carpeting. Do not cover cord with throw rugs, runners or the like. Arrange cord away from traffic areas and where it will not be tripped over.

WARNING - RISK OF FIRE!

To prevent a possible fire, do not block air intake or exhaust in any manner. Do not use on soft surfaces where openings may become blocked.

WARNING - RISK OF FIRE!

Do not blow or place insulation against the firebox.

WARNING: If the information in these instructions is not followed exactly, a fire or explosion may result causing property damage, personal injury or death.

Do not store or use gasoline or other flammable vapors in the vicinity of this or any other heater.

Installing fireplace

Select a suitable location that is not susceptible to moisture and is a safe distance from drapes, furniture and high traffic areas. A qualified electrician should add an electrical outlet per local building codes. See shaded area on recessed installation diagram for proper outlet placement. **Fireplace must be installed to a plumb vertical wall for correct operation of touch controls.**

Note: Follow all national and local electrical codes. This fireplace can be wall-hung or framed in to the wall.

Recessed Installation:

1. Prepare frame opening according to chart.

A40CLX	25" W x 19 3/4" H x 4" D
A60CLX	45" W x 19 3/4" H x 4" D
A100CLX	85" W x 19 3/4" H x 4" D

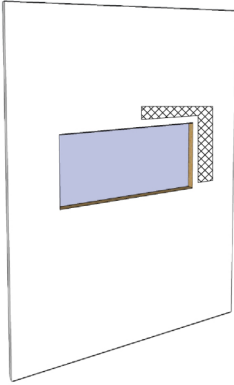

2. Attach L-metal brackets to the fire unit with the provided small washer head screws.

3. Secure fire unit to the finished framed opening with the provided large washer head screws. Make certain that at least 4 of the screws are driven in to a solid backing. Fireplace will stand proud of the finished wall opening by 2.95 cm, this area must not be blocked by any additional trim, tile, etc. as this will block proper air flow.



4. Hang the glass face on the fire unit. Make certain that the hooks from the on the backside of the glass face are secured on all 4 studs on the fire unit.



Wall-hung Installation:

1. Hang the mounting bracket with the included large washer head screws and wall anchors. Wall anchors should be used at the highest outside corners. Be certain that at least two screws are driven in to solid backing.

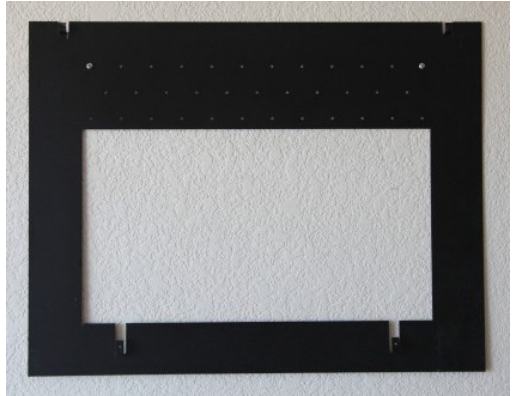

2. Hang the fire unit on the mounting bracket.

3. Hang the glass face on the fire unit. Make certain that the hooks from the on the backside of the glass face are secured on all 4 studs on the fire unit.



Operation

On the bottom of the unit is a main power switch. Switch this on to begin using the fireplace. Directly below the flame, on the right hand side are 3 small LED status lights and 3 buttons.

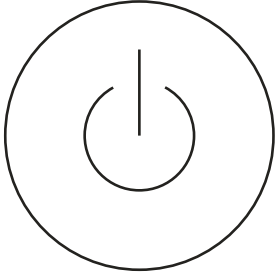

Power



Heat

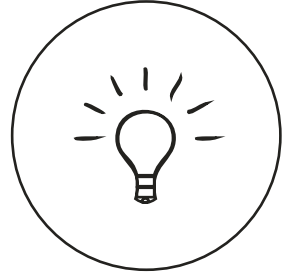

Backlight

When all indicator lights are off, pressing on any button will only show the status. Once the indicator lights are on you can press any button. Press down on the power button to turn the machine on. This will be indicated by 1 green LED light. The Heat button can be pressed multiple times and will turn on low, high and off in that order. The Backlight button turns on high, medium, low and off in that order.

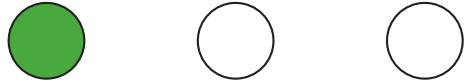

The status light above shows that the power is on and the heater is off



The status light above shows that the power is on and the heater is on low







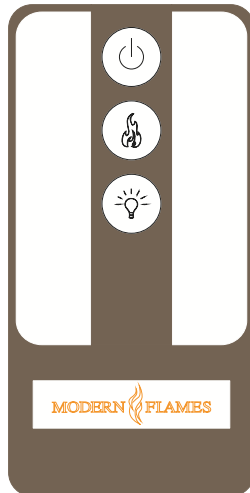

The status light above shows that the power is on and the heater is on high

The included remote functions in the same manner as the buttons on the main unit.



MODERN FLAMES

AL CLX SERVICE PARTS

ITEM	PHOTO	COMMENTS
MFPCB1		Printed circuit board controls low voltage and high voltage functions
MFTC1		LCD TOUCH CONTROL
MFRR1		REMOTE CONTROL IR RECIEVER
MF12VT1		TRANSFORMER
MFHF12015		HEATER FAN 120 V 1500 WATTS
MFHF22015		HEATER FAN 220 V 1500 WATTS
MFSM120		SPINDLE MOTOR 120 V 50-60 HZ
MFSP220		SPINDLE MOTOR 220 V 50-60 HZ

MFLED5		5 WATT LED
MFLED3		3 WATT LED
MF PS1		POWER SWITCH
MFR1		REMOTE CONTROL
AL40SP	INSERT SPINDLE PHOTO	SPINDLE FOR AL1000 CLX
AL60SP		SPINDLE FOR AL1500CLX
AL100 SP		SPINDLE FOR AL2500 CLX
ALGLS40	PHOTO GLASS FACE	GLASS FACE AL1000 CLX (AL40 USA)
ALGLS60		GLASS FACE AL1500 CLX (AL60 USA)
ALGLS100		GLASS FACE AL 2500 CLX (AL100 USA)
ALFMCRY540	PHOTO FIRE MODULE CRYSTALS	FIRE MODULE CRYSTALS AL 1000 CLX (AL40 USA)
ALFMCRY560		FIRE MODULE CRYSTALS AL 1500 CLX (AL60 USA)
ALFMCRY5100		FIRE MODULE CRYSTALS AL2500 CLX (AL100 USA)
ALFMCOAL40	PHOTO FIRE MODULE COALS	FIREMODULE COALS AL 1000 CLX (AL40 USA)
ALFMCOAL60		FIRE MODULE COALS AL 1500 CLX (AL60 USA)
ALFMCOAL100		FIREMODULE COALS 2500 CLX (AL100 USA)
ALFMSTO40	PHOTO FIRE MODULE STONES	FIRE MODULE STONES AL 1000 CLX (AL40 USA)
ALFMSTO60		FIRE MODULE STONES AL 1500 CLX (AL60 USA)
ALFMSTO100		FIRE MODULE STONES AL 2500 CLX (AL100 USA)

Frequently Asked Questions

Q. How do you program the remote control?

A. The remote comes pre-programmed. No programming is necessary.

Q. What distance can the remote be used from the fireplace?

A. Optimal distance for the remote control is within 10 yards.

Q. Can you turn on the fireplace via the touch screen and off via the remote (or vice versa)?

A. Yes.

Q. My touch screen will not operate properly.

A. The fireplace must be installed to a plumb vertical wall for correct operation of touch controls.

Q. How long will the LED lights last?

A. LED Lamps have a life span of up to 20 years.

Q. Can the sensitivity of the touch screen be adjusted?

A. Yes, but only by the factory. Not just any technician will be able to adjust the touch screen sensitivity.

Q. Can the fireplace be installed outside?

A. No. Please review the entire safety chapter before installing this fireplace.

Q. Does the fireplace need to be on a dedicated 15 amp circuit?

A. Yes.

Q. What thickness of sheetrock should be used for the recessed installation?

A. 12 or 15 mm.

Q. How often do the batteries in the remote need to be replaced?

A. Annually, possibly more with heavy use.

Q. Is there a remote receiver in the fireplace that requires batteries?

A. No, only the actual remote requires batteries. The rest of the fireplace runs entirely off of the main power supply.

Troubleshooting

SYMPTOM	PROBLEM	TEST SOLUTION
Appliance turns off and will not turn on	Appliance has overheated and safety device has caused the thermal switch to disconnect	Unplug the appliance, allow appliance to cool for 15 minutes, then plug it back in
	House circuit breaker has tripped	Reset house circuit breaker
Appliance will not come on when switch is flipped to ON	Appliance is not plugged into an electrical outlet	Check plug and plug it in if necessary
	Appliance has overheated and safety device has caused the thermal switch to disconnect	Unplug the appliance, allow appliance to cool for 15 minutes, then plug it back in
Remote control does not work	Low batteries	Replace batteries in remote control

© 2011

MODERN  FLAMES